

Filo muro/ frameless, flush to the wall

EURO DOOR



DAYORIS
DOORS

Types of Applications



Finishes

Primed / Laminated Import
 Laminated Suncrest / Matte Lacquer
 Wood veneer

Cabinet Knob



L Profile



Cabinet Style Hinge



What's included

Technical Specifications:
 1" Solid Core MDF Door
 Finish – Designer's choice
 Frame – Concealed aluminum
 Design – Designers Choice

Frame Profile Finishes

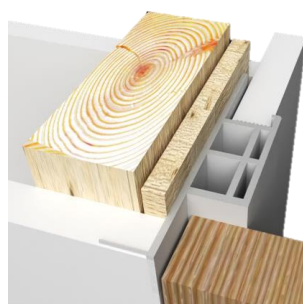

Clear Aluminum Frame

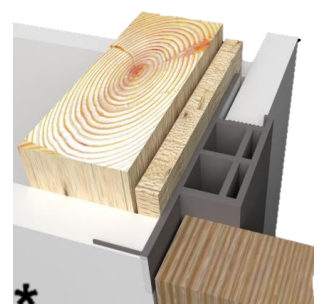

* Black Aluminum Frame

* Optional Upgrades

Benefits of Filo muro/ euro door

Drywall
Return

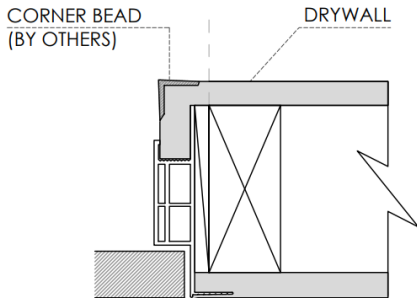

Any Wall
Thickness

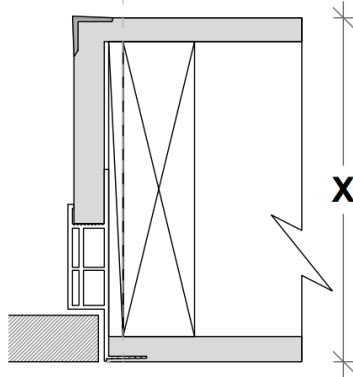

Lighter Door and
Space saver

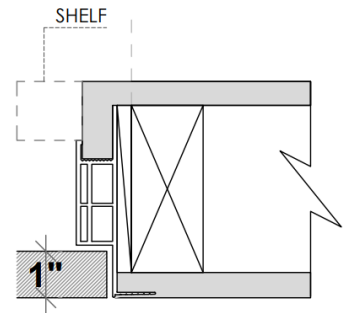

A thinner, economical application for non walk-in closets

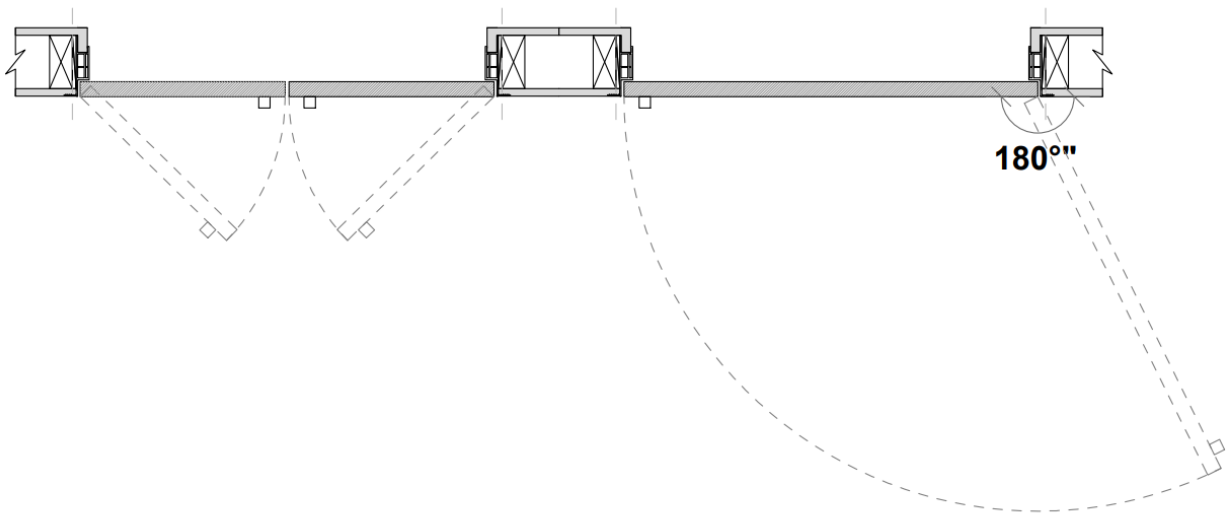

Works with 1/2" depth reglet (any height). Can be used with 5/8" drywall.

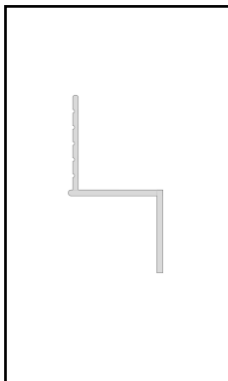

DEPTH	WIDTH	NON-VENTED
1/2"	1/8"	DRMZ-25-125
1/2"	1/4"	DRMZ-50-25
1/2"	3/8"	DRMZ-50-375
1/2"	1/2"	DRMZ-50-50
1/2"	5/8"	DRMZ-50-625
1/2"	3/4"	DRMZ-50-75
1/2"	1"	DRMZ-50-100
1/2"	1 1/2"	DRMZ-50-150
1/2"	2"	DRMZ-50-200

* Fry reglet for reference purposes only, not provided by Dayoris.

Framing Instructions Filo muro/ euro door

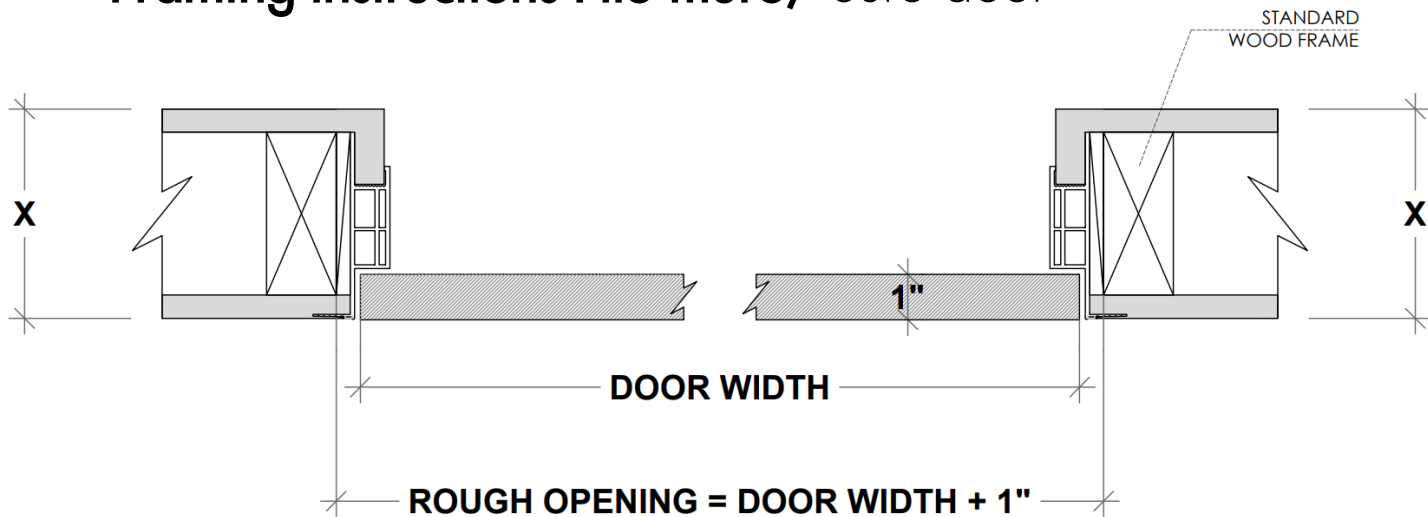

X = THE WALL CAN BE ANY THICKNESS
ALL OPENINGS MUST HAVE WOOD SUPPORT (2" x 4", 2" x 6", 2" x 8", ...)

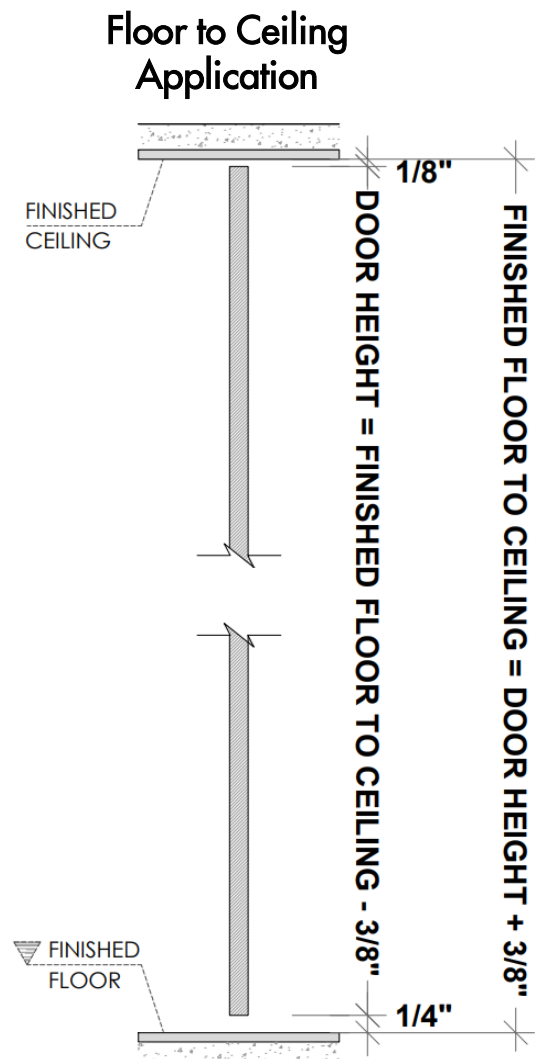
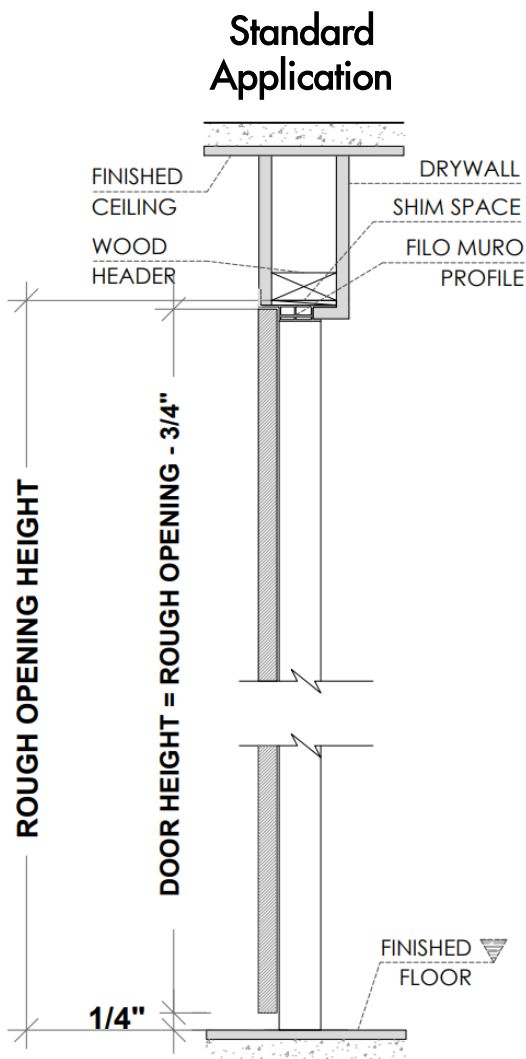

PLEASE ACCOUNT FOR FINISHED FLOOR FOR ALL MEASUREMENTS GIVEN TO DAYORIS.

Outswing Application (euro door only available outswing)

Right Hand Outswing

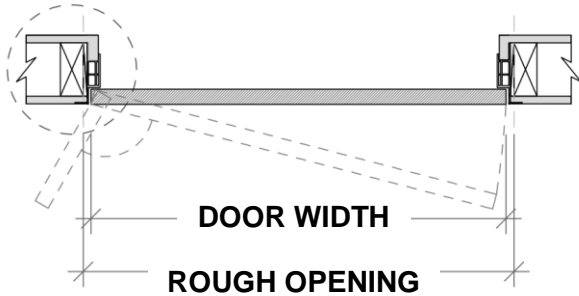

Left Hand Outswing

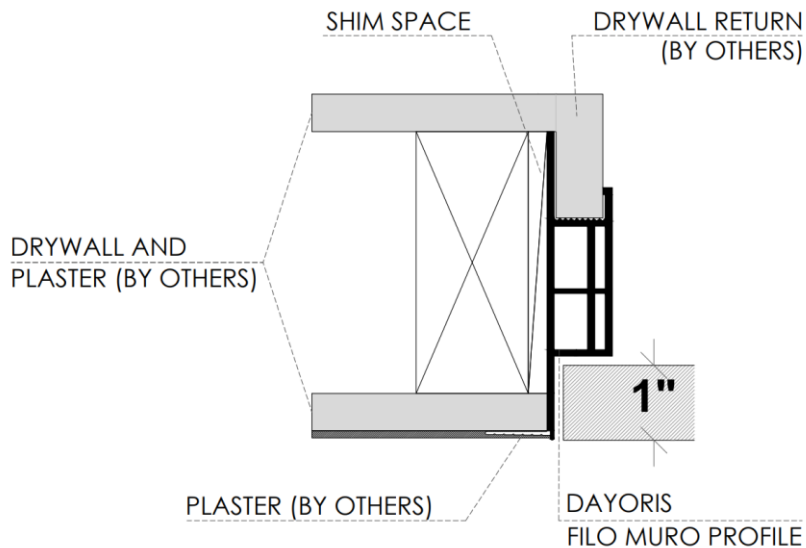
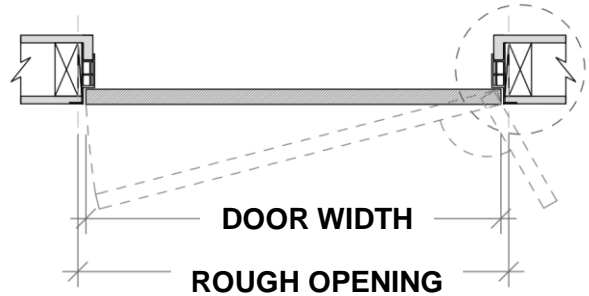

Double Door Applications

Double Dummy Application (both active)

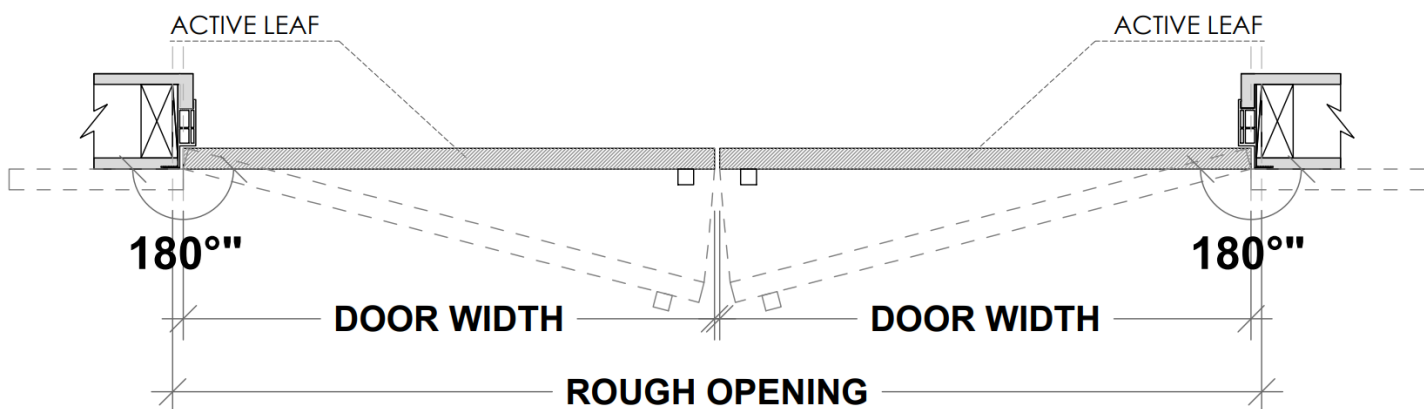

$$\text{ROUGH OPENING} = (\text{DOOR WIDTH} \times 2) + 1''$$

Filo muro/ euro door

1. Wood Frame with 2x4 (by others)



Filo muro/ euro door

2. Filo muro Euro Door Profile Installation

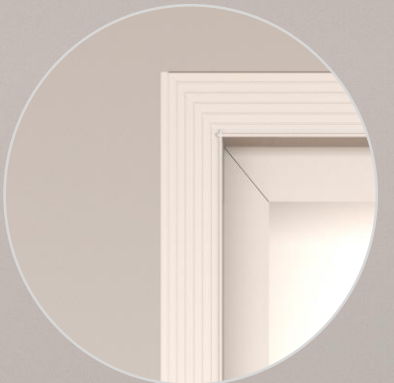
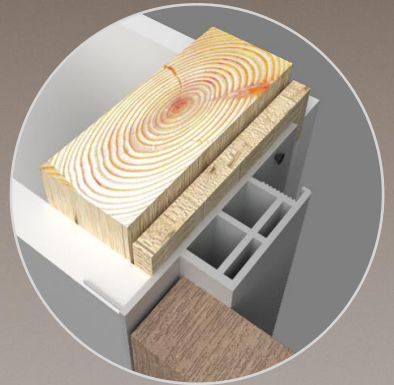

Filo muro/ euro door

3. Euro Door Installation

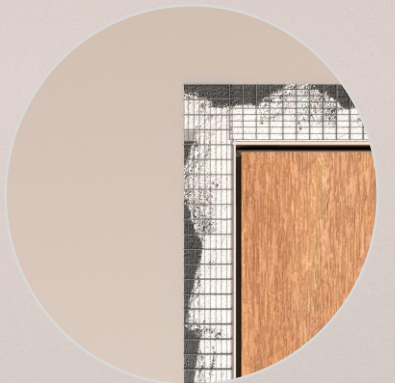
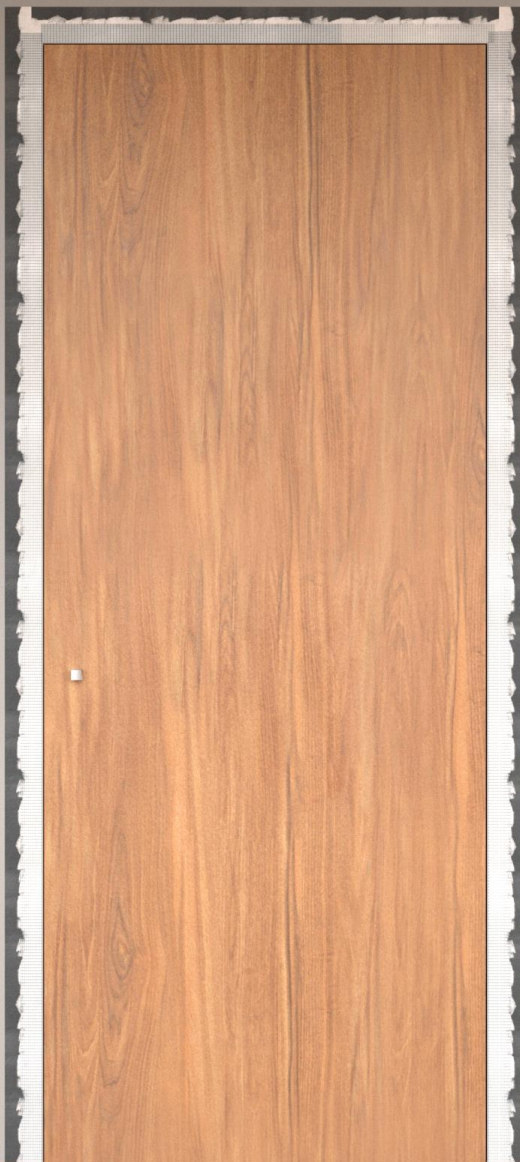

Filo muro/ euro door

4. Finished Euro Door Installation

